

Montageanleitung

8601-A

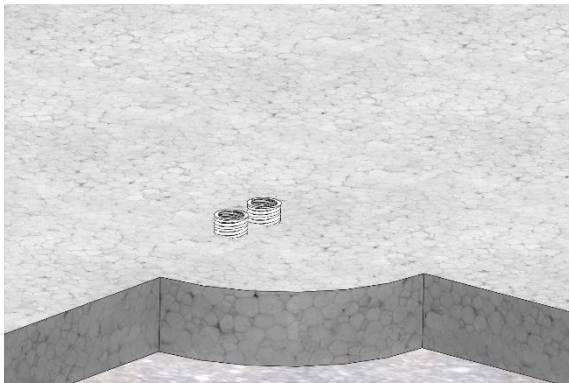

Die Kabel werden von unten zugeführt

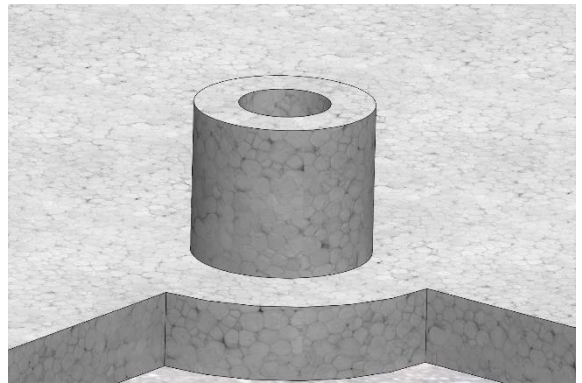

Styroporblock
ca. Durchmesser 118mm x Höhe 100mm

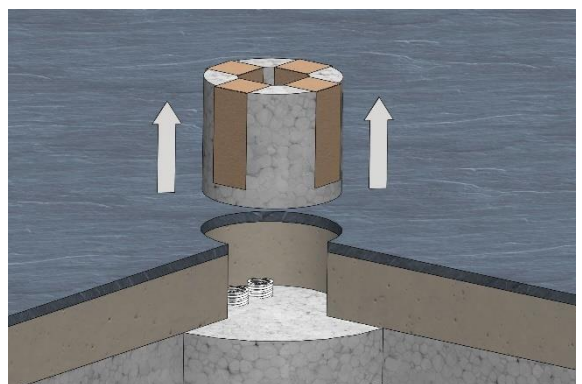
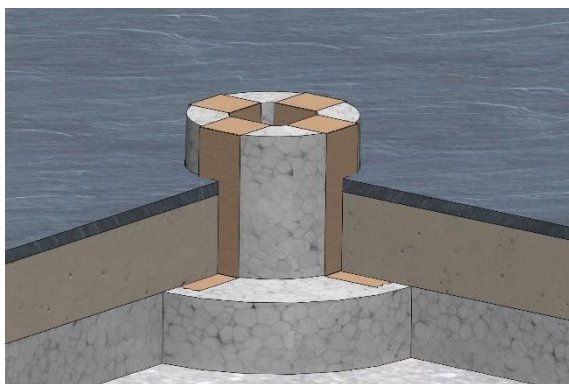
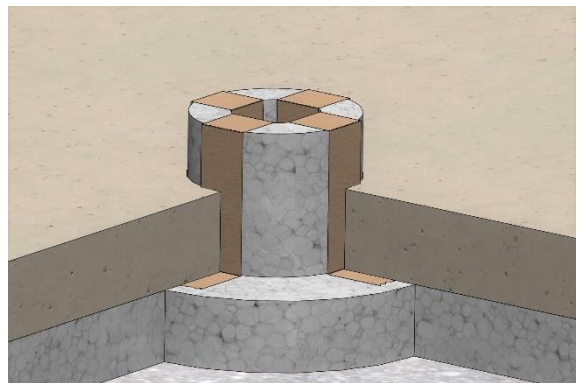
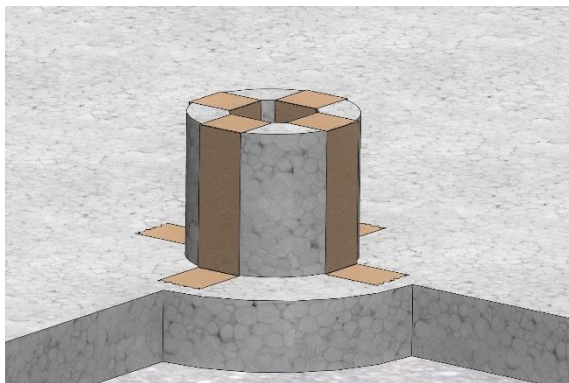

Montageanleitung

8601-A

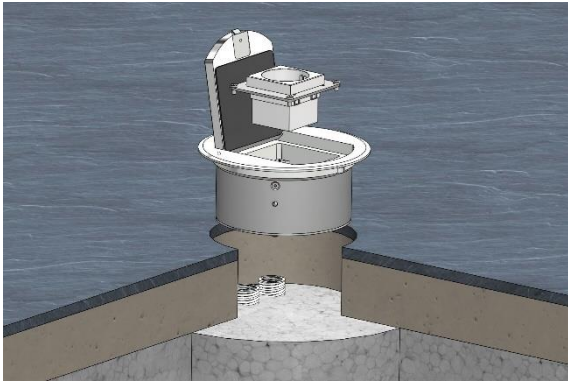

Geräteträger aus Dose herausnehmen

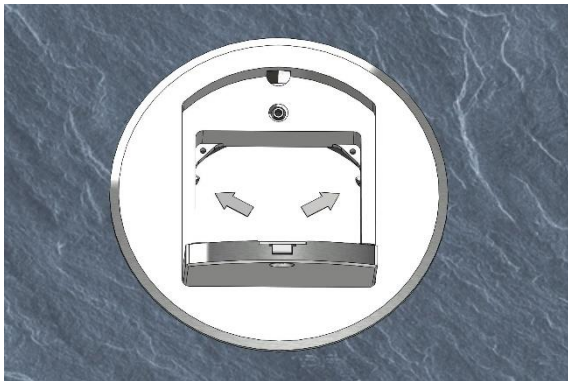
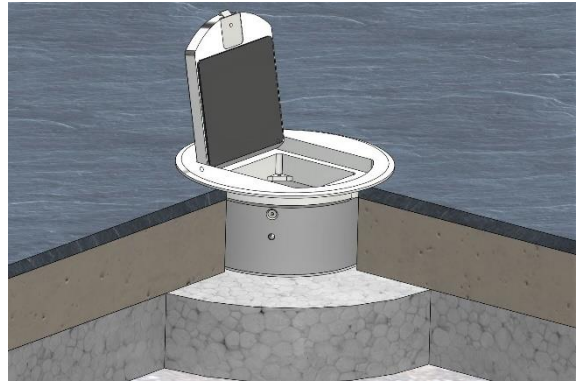

Dose mit Stiftschrauben verankern

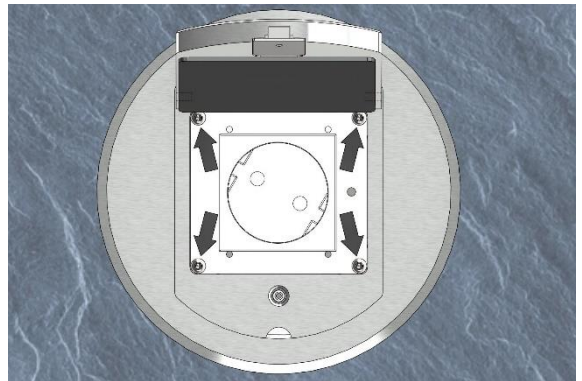

Geräte anschließen
Geräteträger festschrauben

